

# Vertical section v6.1

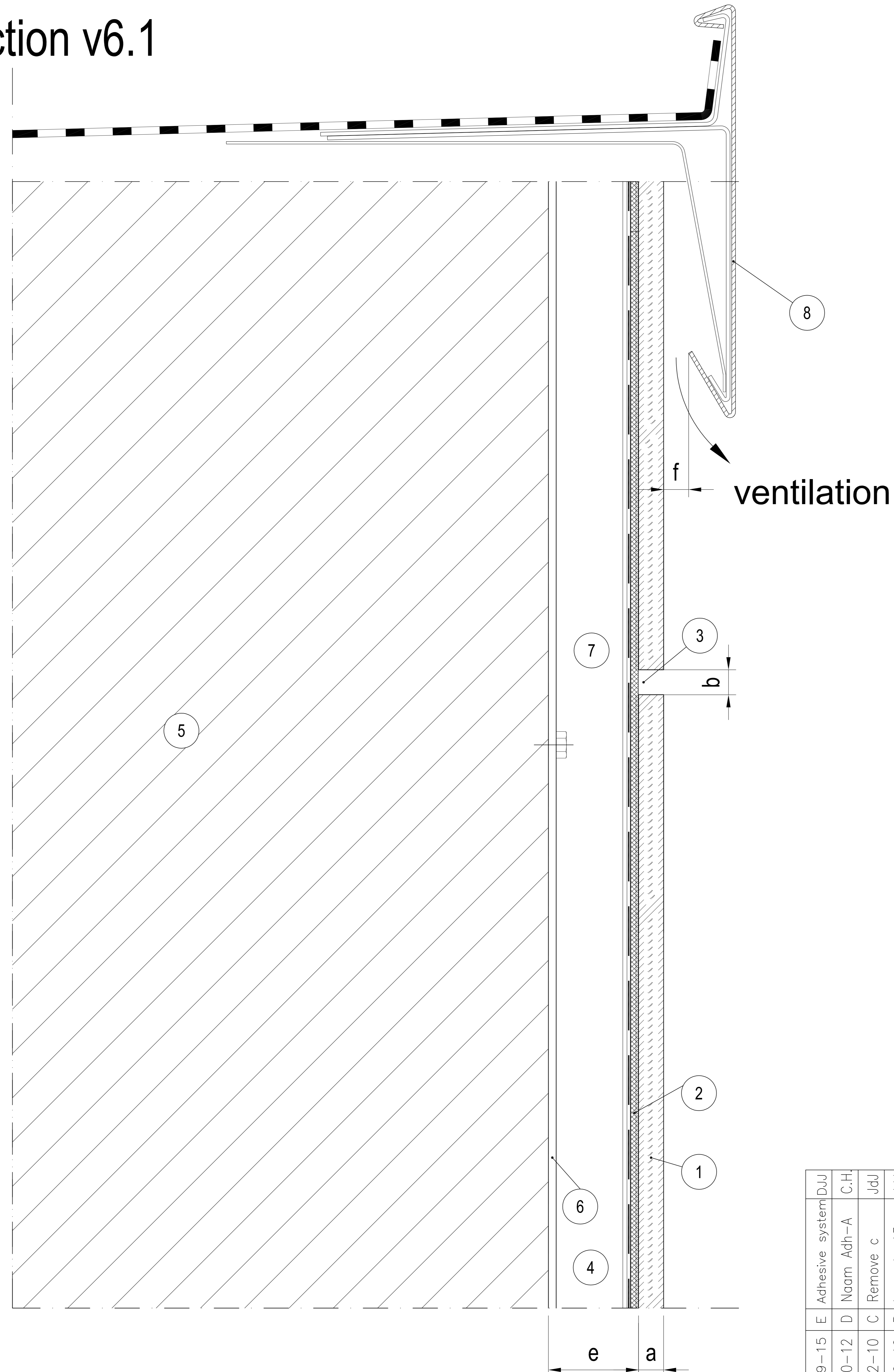

|   |                                  |
|---|----------------------------------|
| 1 | Trespa® Meteoron® panel          |
| 2 | Adhesive system                  |
| 3 | Horizontal joint (Various opt)   |
| 4 | Top Hat                          |
| 5 | Wall Frame                       |
| 6 | (UV resistant) breather membrane |
| 7 | Ventilated cavity                |
| 8 | Capping                          |

|   |   |
|---|---|
| a | Panel thickness (6, 8 or 10 mm)   |
| b | Joint width 10 mm<br>Based on applicable building standards, regulations or certificates, wider joints may be permissible |
| e | Ventilation min. 20 mm<br>Recommended max. cavity depth (between rainscreen cladding and insulation): 50 mm               |
| f | Distance min. 5 mm  |

|          |   |                 |     |      |     |     |     |                     |            |                  |         |   |           |          |       |
|----------|---|-----------------|-----|------|-----|-----|-----|---------------------|------------|------------------|---------|---|-----------|----------|-------|
| 22-09-15 | E | Adhesive system | DJJ | C.H. | JdJ | JdJ | JdJ | Building/Department | Alg.       | TRESPA®          | Remarks | A3  | TS400v1.1 |          |       |
| 02-10-12 | D | Naam Adh-A      |     |      |     |     |     | Drawn de Jonge      | Maart 2008 | Passingen I.S.O. |         | Size  | Number    | Revision | Sheet |
| 20-12-10 | C | Remove c        |     |      |     |     |     | Date                | Maart 2008 |                  |         |   |           |          |       |
| 18-10-10 | B | Legenda 13mm    | JdJ |      |     |     |     | Scale               | 1:2        |                  | Name    | Façade cladding with Trespa Meteoron Adh-A Detail v6.1 - Roofborder cover |           |          |       |
| 07-07-09 | A | Geheel herzien  | JdJ |      |     |     |     | Date                |            |                  |         |   |           |          |       |